

# PARCEL 1 INFORMATION

**Legal:** NW 1/4 & SW 1/4 Section 10-157N-67W, Atkins Township, Towner County, ND

**Deeded Acres:** 320 +/-

**2011 Real Estate Taxes:** \$1,446.66

**FSA Cropland Acres:** 294

**CRP Cropland Acres:**

**195.6 acres** @ \$46.11/acre, \$9,019 annual payment, expires 2021. CRP contract may be terminated at buyer's request with 25% of one year's payment as penalty. If taken out of CRP, chemical burn-down and field preparation may begin upon possession.

**90 acres** (in SW 1/4) was in CRP but was cancelled in July 2012. No penalty will be assessed to the buyer. Buyer may do chemical burn-down & field preparation upon possession.

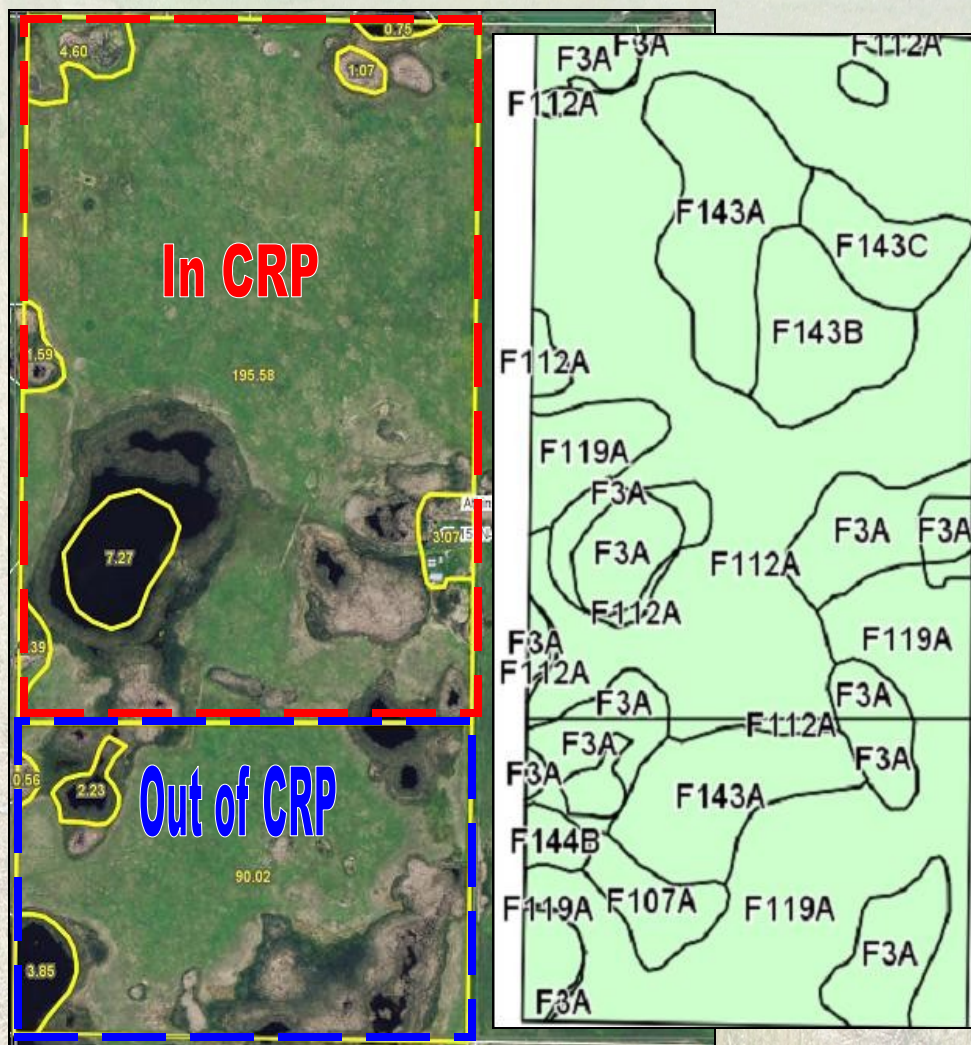



# PARCEL 2 INFORMATION

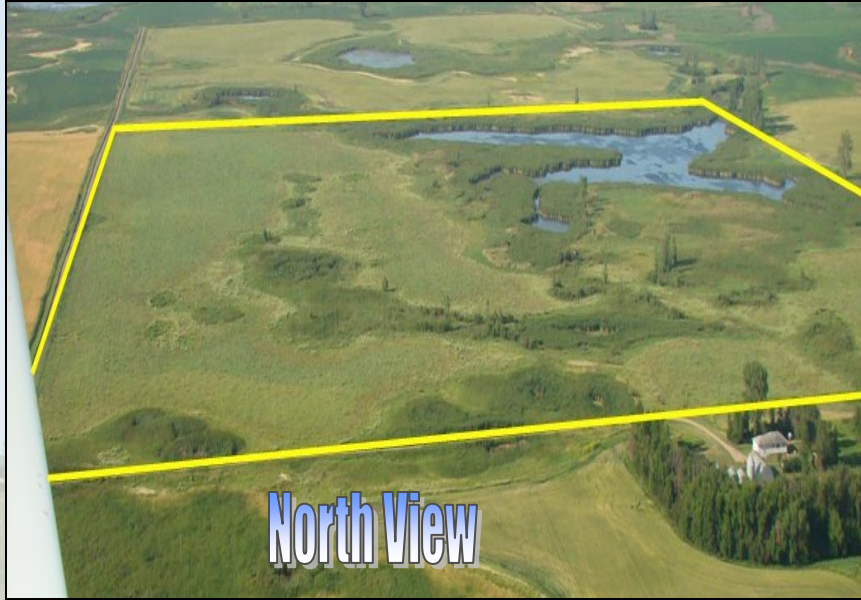

**Legal:** NE 1/4 Section 33-157N-67W, Atkins Township, Towner County, ND

**Deeded Acres:** 160 +/-

**2011 Real Estate Taxes:** \$734.49

**FSA Cropland Acres:** 109.5

**CRP Cropland Acres:**

**99 acres** @ \$49.23/acre, \$4,874 annual payment, expires 2021. CRP contract may be terminated at buyer's request with 25% of one year's payment as penalty. Chemical burn-down and field preparation may begin upon possession.

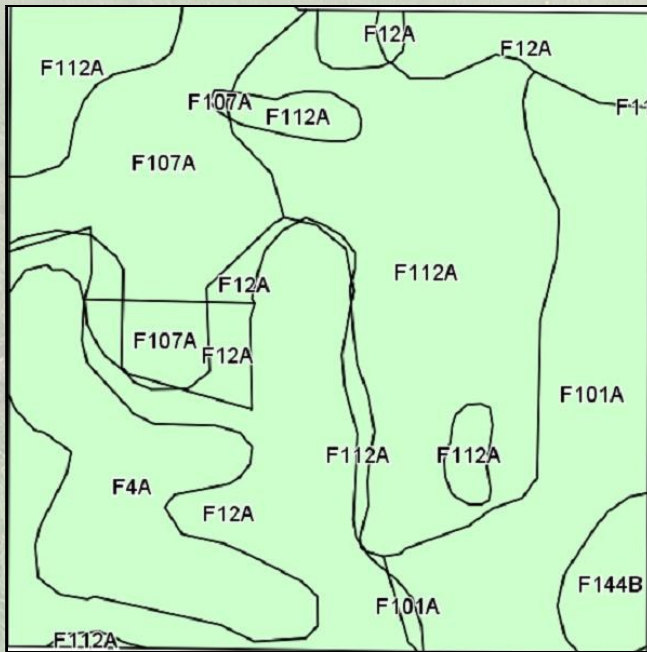

Code	Soil Description	Acres	Percent Of Field	Non-Irr Class	Productivity Index
F112A	Hamery-Tonka-Parnell complex, 0 to 3 percent slopes	49.2	31.2%	11w	77
F12A	Vallers, Saline-Parnell complex, 0 to 1 percent slopes	38.2	24.2%	11lw	56
F101A	Hamery-Wyard loams, 0 to 3 percent slopes	26.1	16.5%	11c	82
F107A	Hamery-Barnes loams, 0 to 3 percent slopes	20.9	13.2%	11c	83
F4A	Souham silty clay loam, 0 to 1 percent slopes	19.3	12.2%	11lw	46
F144B	Barnes-Buse loams, 3 to 6 percent slopes	4.2	2.7%	11e	73
Weighted Average					69.6



**Cando Auction & Real Estate 877.812.4305**